

## Locktronix AEM560 Manual

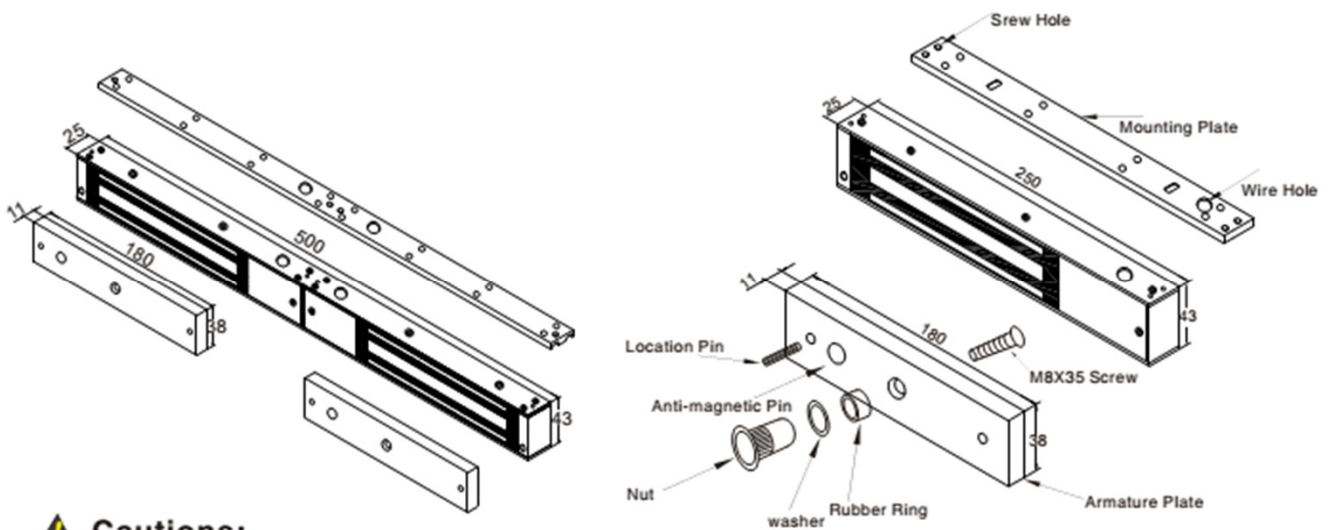

### ⚠ Cautions:

The screw of armature plate should not be fixed too tight .  
Proper elasticity  
should be guaranteed for the rubber ring so that the armature  
plate can adjust  
itself to the appropriate position.

Check the jumper's position before connecting. Figure out it  
represents 12VDC  
or 24VDC.

## Locktronix AEM560 Manual

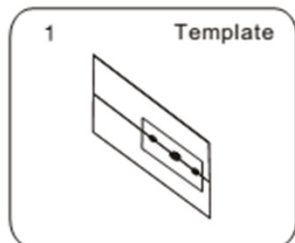
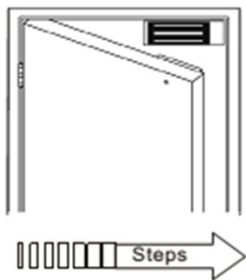

Fold the plate to 90° .

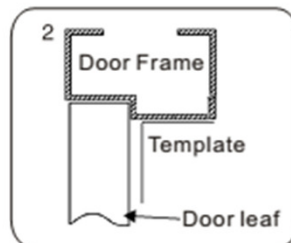

Close the door first, then place the upper side of template on door frame, while adjust the left side next to the door leaf.

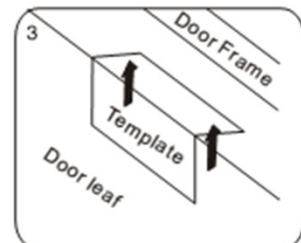

Mark screw positions of armature plate and magnetic lock on door leaf and door frame respectively.

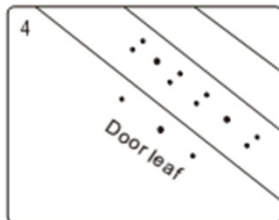

Drill holes based on the marked positions.

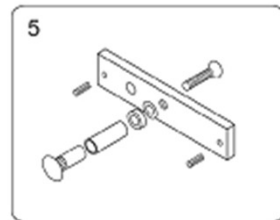

Make a combination based on the picture.

Hollow Metal Door

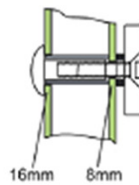

Drill a hole  
Inside: Diameter is 8mm  
Outside: Diameter is 16mm

Wooden Door

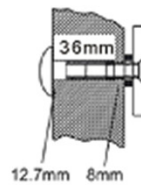

Drill a hole  
Inside: Diameter is 8mm  
Outside: Diameter is 12.7mm

Metal Surface Door

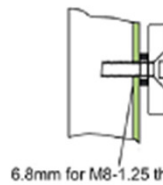

Inside: Drill a hole diameter is 8mm folding the plastic straight pin

## Locktronix AEM560 Manual

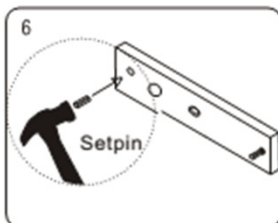

Strike the pin into the armature plate slightly (to avoid movement).

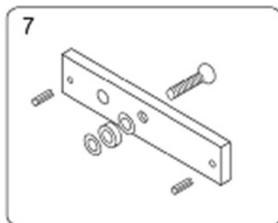

Make a combination based on the picture (add washer accordingly). The rubber ring must be added.

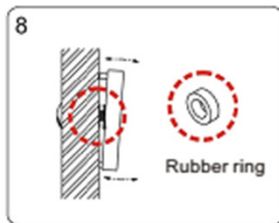

Place the rubber ring between armature plate and door leaf.

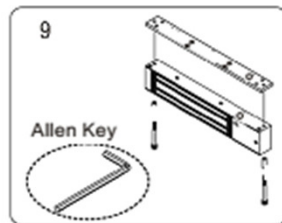

Use Allen key to remove the mounting plate from lock body.

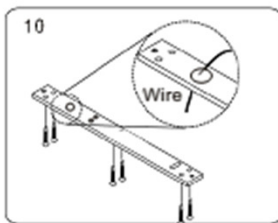

Fix the mounting plate on the door frame according to the holes drilled earlier.

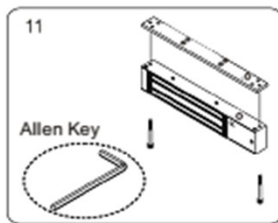

Use Allen key to screw the lock body on the mounting plate.

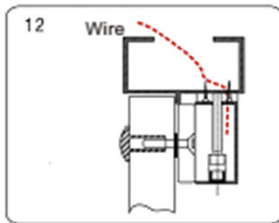

Close the door to test holding force. The angle between armature plate and magnetic lock can be adjusted by adding or reducing washers.

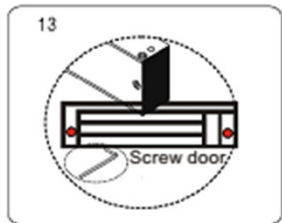

After all the appropriate procedures, the holding force can be maximized. Finally, fix the tamper screw.

## Locktronix AEM560 Manual

Different brackets are available according to different types of doors. For example, narrow door, frameless glass door and inward opening door.

### L Bracket-For outward opening door

When the door frame thickness is less than 42mm, L bracket is needed.

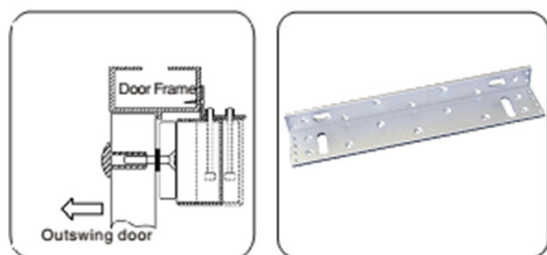

### ZL Bracket-For inward opening door

For inward opening door, ZL bracket is needed.

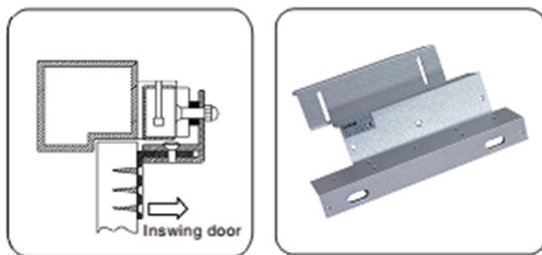

### U Bracket

For the frameless glass door. U bracket is needed.

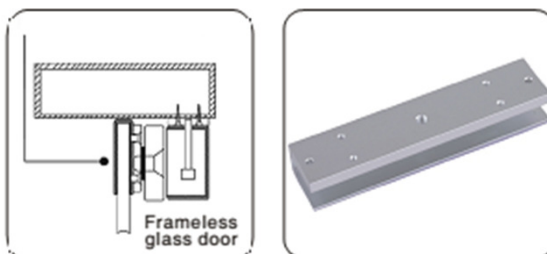

### I Bracket for armature plate

When the door frame is too thick, I bracket is needed.

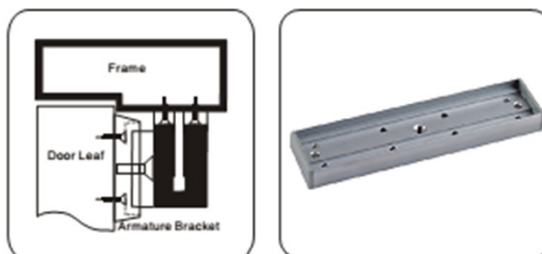

## Locktronix AEM560 Manual



Demonstration of I Bracket Installation

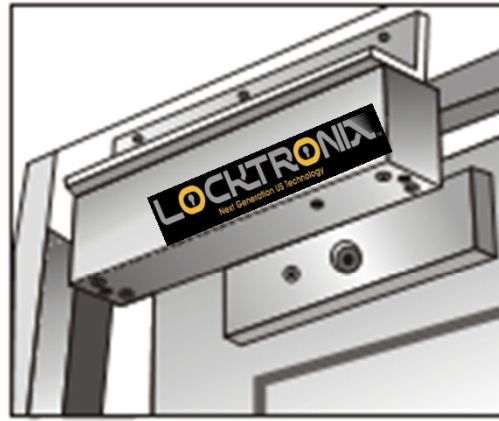

Demonstration of L Bracket Installation

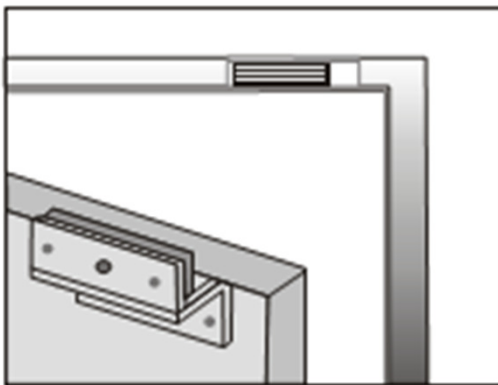

Demonstration of ZL Bracket Installation

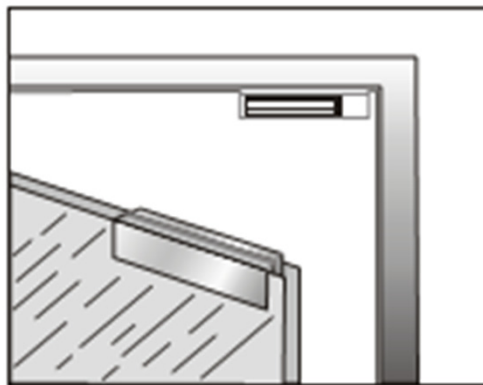

Demonstration of UL Bracket Installation